

## AXE<sup>RT</sup>

### Roof Top - Railless

#### Durable

Aluminium brackets with stainless steel fittings for the toughest environmental conditions.

#### Economical

Cost competitive, functional design with minimal number of tools needed, reducing installation costs.

#### Versatile

Compatible to a wide range of roof sheeting types.

#### Effortless

Innovative design for time saving installation methods with a modular and practical integrated solution.

|                           |                                                                                                                                                                                  |
|---------------------------|----------------------------------------------------------------------------------------------------------------------------------------------------------------------------------|
| <b>Additions</b>          | Cable clips to panel frames                                                                                                                                                      |
| <b>Roof types</b>         | Fix Lok (Saflok/Klip-Lok/ProLok), Spring Lok<br>Trapezoidal (IBR)<br>Corrugated<br>Pinch Fix (Brownbuilt/Craft-Lock/Dimondek)<br>Consult for other roof types                    |
| <b>Module orientation</b> | Landscape and portrait on selected roof types                                                                                                                                    |
| <b>Standards</b>          | SANS 10160      Structural design<br>SANS 10162      Structural use of steel<br>IEC 62548        PV array design requirements<br>Eurocode 9        Design of aluminium structure |
| <b>Materials</b>          | Small parts      Stainless steel (A2)<br>Available in Stainless steel (A4)<br>Extruded aluminium (6063 T6)<br>Available in 25µm anodising layer                                  |
| <b>Certification</b>      | ISO 9001                                                                                                                                                                         |
| <b>Warranty</b>           | 10 years <sup>1</sup>                                                                                                                                                            |

Nuts in Bracket for Clamp connection

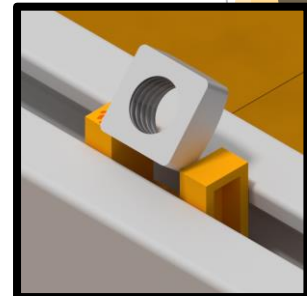

Clamp connection to roof bracket

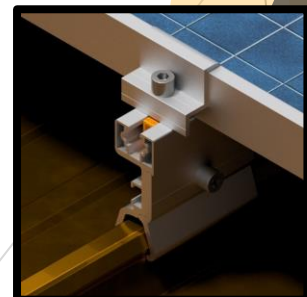

<sup>1</sup> For terms and conditions please refer to the Axe Struct Warranty Terms.