

# AXE | STRUCT

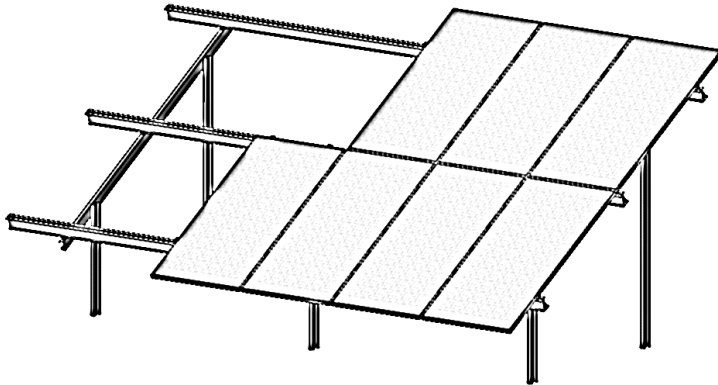

## AXE<sup>GM</sup>

### Ground Mount - Economical

#### Durable

Aluminium and hot-dip galvanised steel for the toughest environmental conditions.

#### Economical

Cost competitive, functional design with minimal number of tools needed, reducing installation costs.

#### Trust

Conservative coefficient selections in structural design to assure resistance to failure.

#### Effortless

Innovative design for time saving installation methods with a modular and practical integrated solution.

<b>Application</b>	Ground mount
<b>Module orientation</b>	Portrait (cost effective) and landscape
<b>Module layout</b>	Landscape: Up to 8 high Portrait: Up to 4 high
<b>Module inclination</b>	10° to 25° angle
<b>Table length</b>	Up to 33 meters
<b>Support spacing</b>	In accordance with static calculations Up to 5 meters, depending on module inclination End overhang of up to 1.5 meter
<b>Ground clearance</b>	Various
<b>Foundation</b>	Posts driven into soil Bored holes and concrete posts in position Slotted footplates connected to casted threaded rods Posts casted into reinforced concrete
<b>Standards</b>	SANS 10160 Structural design SANS 10162 Structural use of steel ISO 1461 Hot dip galvanized coatings Eurocode 9 Design of aluminium structure
<b>Materials</b>	Support rails Extruded aluminium (6063 T5) Rafters and Upright posts Hot-dip galvanised lipped channel (S355) Small parts Hot-dip galvanised steel (8.8) Stainless steel (A2) Extruded aluminium (6063 T6)
<b>Manufactured</b>	100% South African produced and fabricated
<b>Warranty</b>	10 years <sup>1</sup>

Nuts in Rail for Clamp connection

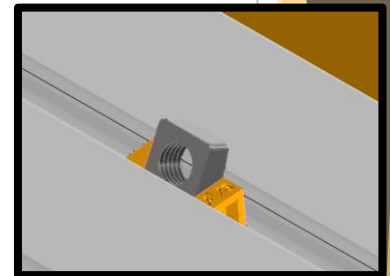

Rail connections to rafter

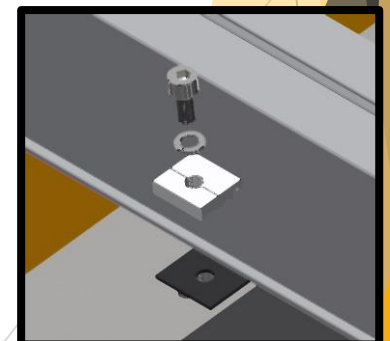

<sup>1</sup> For terms and conditions please refer to the Axe Struct Warranty Terms.